

ARROW

SEWING FURNITURE

Where Creativity Meets Color!

JUDY

SEWING MACHINE CABINET

OWNER'S MANUAL

Assembly Instructions

Model Numbers:

101 | White

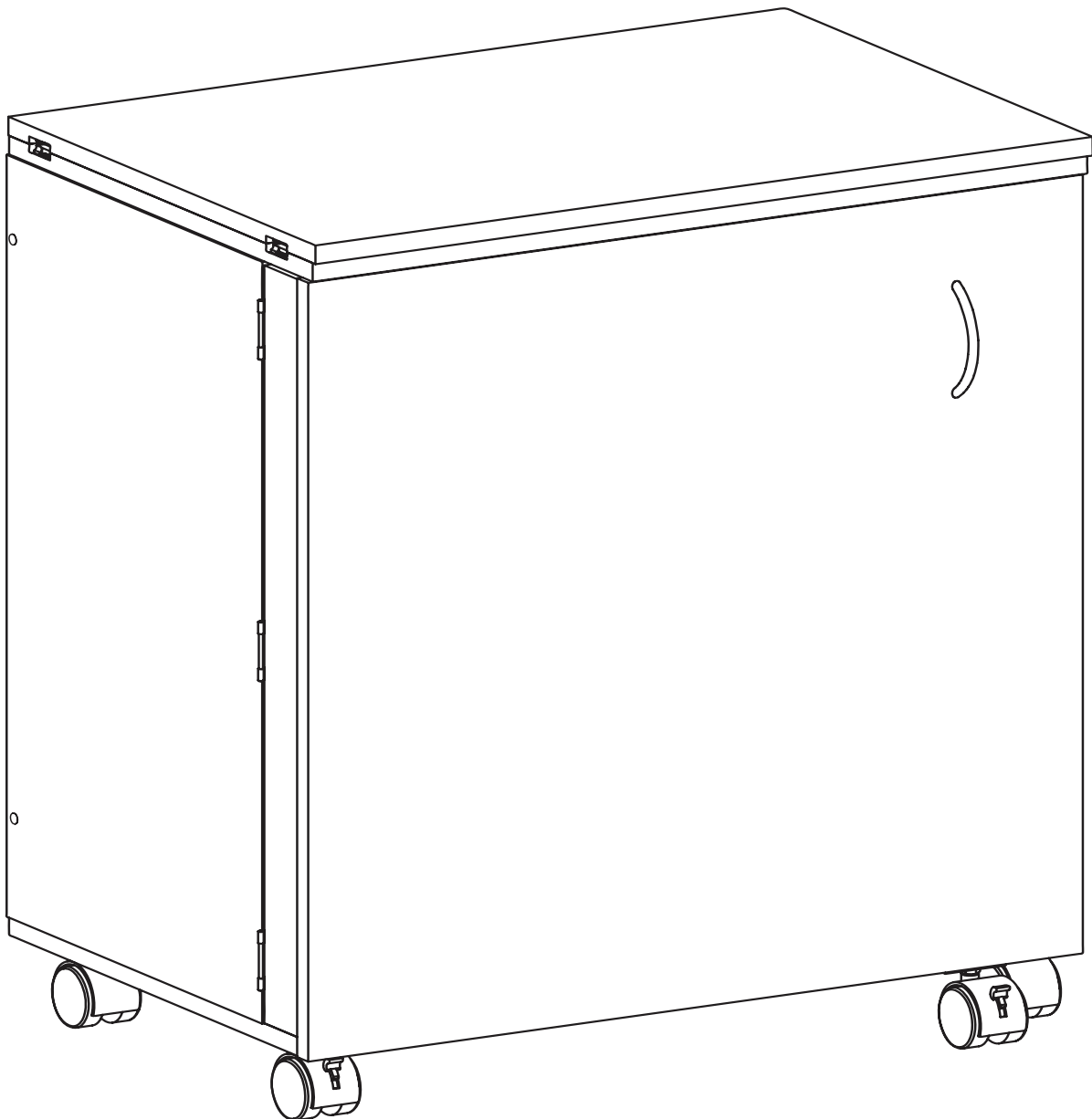

IMPORTANT: Please read these instructions before assembling!

READ THIS PAGE FIRST



WARNING:
CHOKING HAZARD – Small parts. Not for children under 3 years.
Please retain this information for future reference.



ARROW WARRANTY

Congratulations on the purchase of your new JUDY sewing cabinet. Every effort has been taken to ensure your complete satisfaction with this custom designed product. For your convenience, the ready-to-assemble JUDY cabinet is provided in two boxes.

Helpful Assembly Hints

Read the instructions carefully before starting. Please open and inspect the contents of both boxes to see that all parts are included. You will need a Phillips head and a flat head screw driver. A power screwdriver or cordless drill is preferable. Ensure that the Phillips head fits neatly and fully engages the screw to avoid damage to the screws. Make sure that you tighten all screws securely and tap wooden dowels all the way in.

Warranty Information

We warranty our product for 10 years from date of shipment for manufacturer's defect and shipping damage within first 15 days. The warranty does not cover damage caused by abuse, mis-use, alteration, accident, or neglect of the product. The warranty does not cover damage caused by moving the cabinet fully loaded. Under the terms of this warranty, the repair and replacement of any parts shall be at the discretion of the company or their designated representative.

Replacement Parts Shipping Policy

To help protect our valuable resources, we ship all replacement parts at the same time. This procedure lessens the use of packaging materials and fossil fuels used in transportation keeping our world a cleaner place. Please help us in this endeavor by reviewing all parts in all boxes for damage before calling or emailing us to report damage. We adhere to this environmental philosophy by only shipping replacement parts 1 time for free. Future parts will be billed at customer's expense.

Cabinet Care

Your cabinet normally requires a minimum amount of maintenance, however, the following points are worth noting:

CLEANING- To remove marks and enhance the surface, wipe with general purpose cleaner.

CAUTION- Do not use ammonia based cleaning agents. Do not use harsh chemicals or abrasive cleansers. The surface can be wiped with a damp cloth but should be dried quickly.

Register online at www.arrowcabinets.com/warranty

FOLLOW US ON FACEBOOK AND CHECK OUT OUR COOL CONTESTS!

If you have any questions, please call or email us at:

1-800-533-7347 Ext. 1
cs@arrowcabinets.com

Check out our website for pictures and frequently asked questions at:

www.arrowcabinets.com

Notice to Customer:

Before beginning assembly, remove all parts from the carton. Please review the illustrations below to determine that all parts are Included.

For assembly or operating assistance, or to report any missing or damaged parts, you may call or write to:

cs@arrowcabinets.com

1-800-533-7347 Ext. 1

Arrow Cabinets

P.O. Box 307, Delavan, WI 53115

TO ORDER REPLACEMENT PARTS CALL

1-800-533-7347

NOTE: To assure proper handling of replacement parts please include the following information:

- **Model Number of Unit**
- **Production ID Number**
- **Number of Part Required**
- **Your Name, Address, and Phone Number**

Wooden Materials

Parts are labeled with capital letters. To reference letters, turn to the Wood Parts List in the back of your manual.

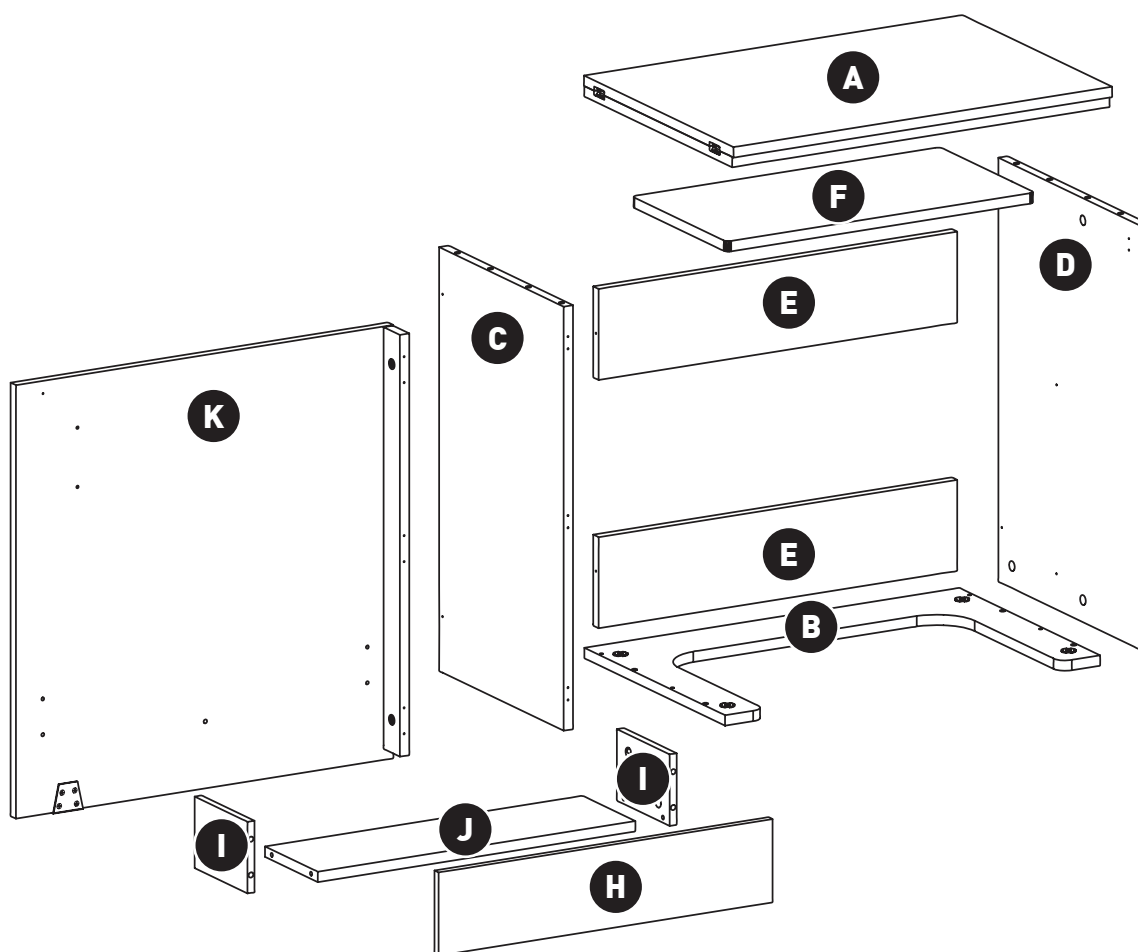

A Top/Leaf

B Bottom Panel

C Left Side Panel

D Right Side Panel

E Back Top/Bottom Panels

F Platform

H Door Bin Front Panel

I Door Bin Sides

J Door Bin Bottom

K Door

If any of these parts arrived damaged, please call us at **1-800-533-7347** and we will send a replacement part out.

For additional strength dab wood glue on tip of screws before attaching.

Hardware Included

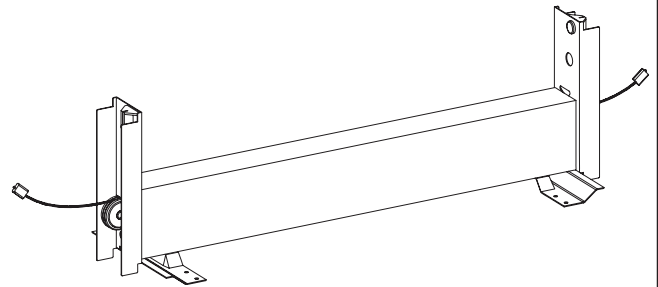
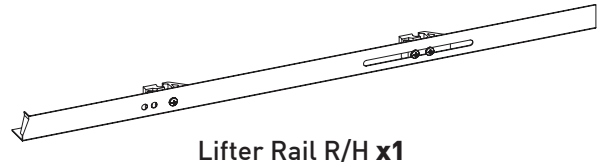
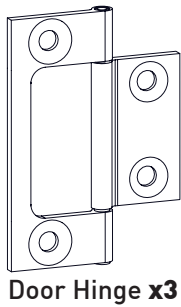
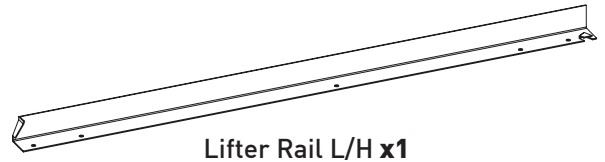
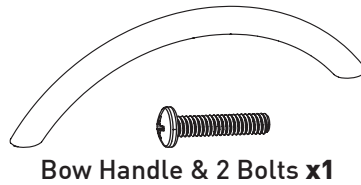
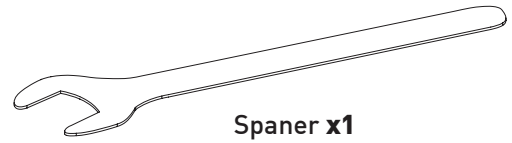
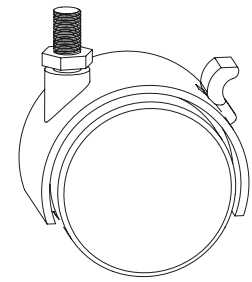
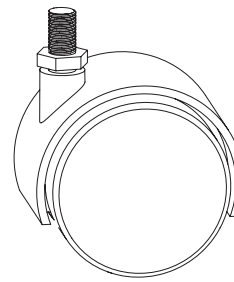
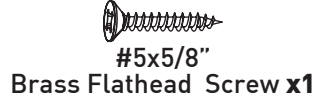
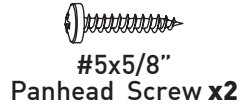
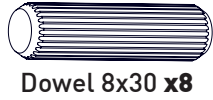
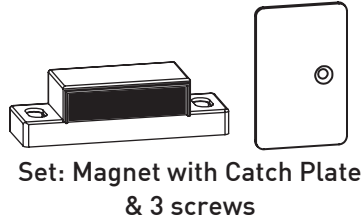
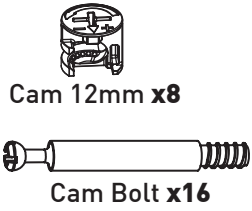

*Screws are NOT separated into individual bags, they are in the bags with the item you will use them with.
Example: Screws for the door hinges are in with the door hinges.

*Items not drawn to scale.



Tools required

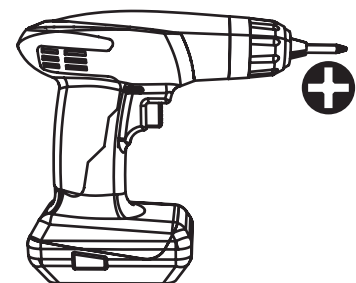
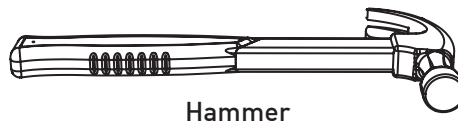
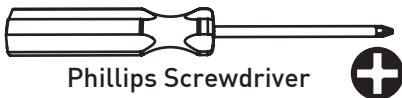

Understanding How the "ARROW-LOC" Cam Fastener Works

	<p>ARROW TOWARDS HOLE IN EDGE!</p>		<p>180°</p>
<p>Position bolt in pre-drilled hole and turn until tight.</p>	<p>Press cam into pre-drilled hole until flush with surface.</p>	<p>Insert bolt through pre-drilled hole in edge of panel.</p>	<p>To lock, rotate cam until tight, using screwdriver.</p>

Cabinet Assembly

Step 1. Place Top (A), Bottom (B), Door (K) and Door Bin Front Panel (H) on a flat protected surface to prevent scratching of parts, thread cam bolts (16 total) into pre-drilled holes (as shown in FIG. 1).

FIG. 1

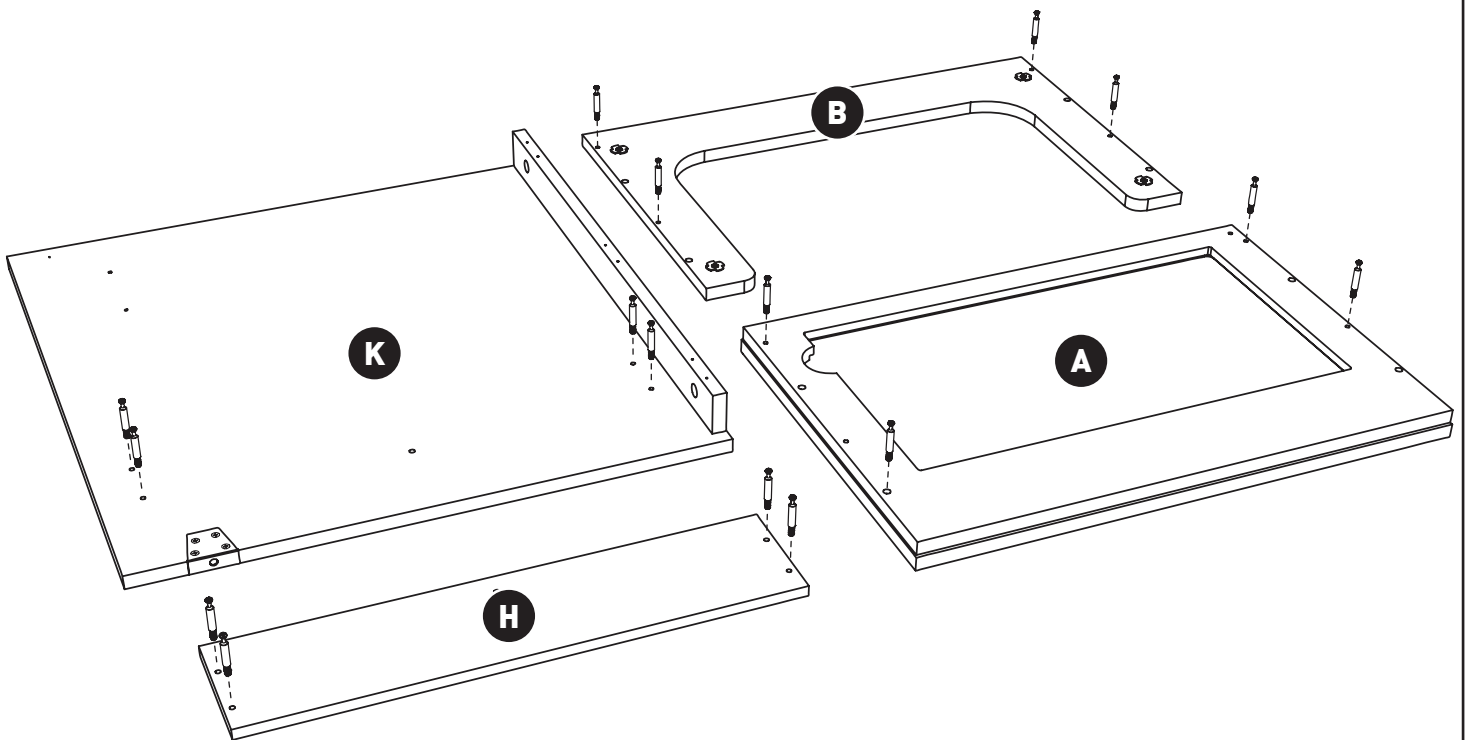
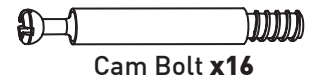

Step 2. Install Cams (8 total) by pushing a cam into each hole flush with surface, the arrow on the cams should be turned (using a regular screwdriver) to face the hole in each edge where the cam bolts will enter.

After installing the cams, insert the Dowels 8x30 (x8) in the both Side panels (C & D) as shown in FIG. 2.

FIG. 2

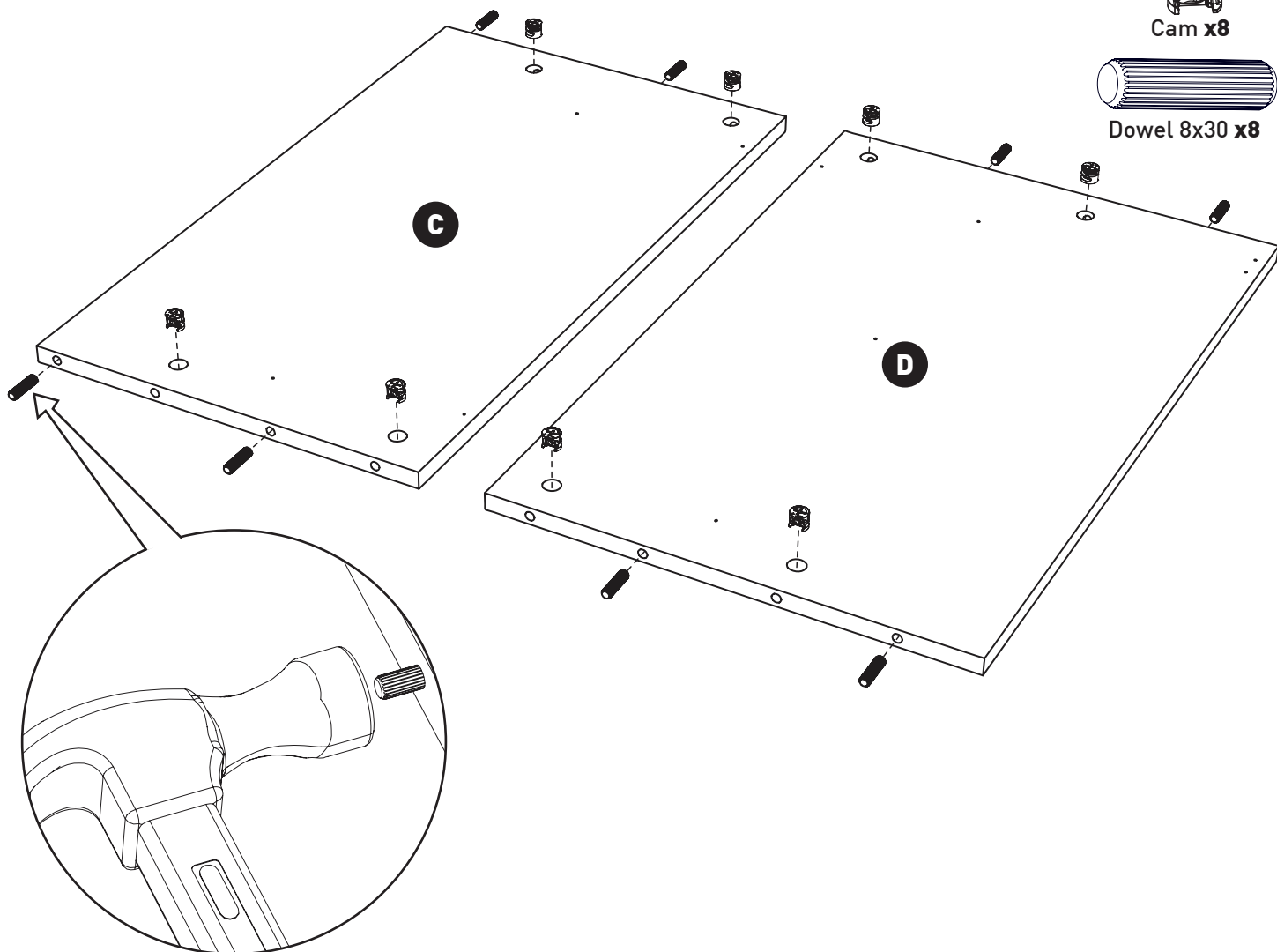

Step 3. Attach magnet with #5x5/8 Brass Panhead Screws (x2) packed with magnet to Right Side Panel (D) into the pre-drilled holes so that the metal part is facing front edge.

FIG. 3

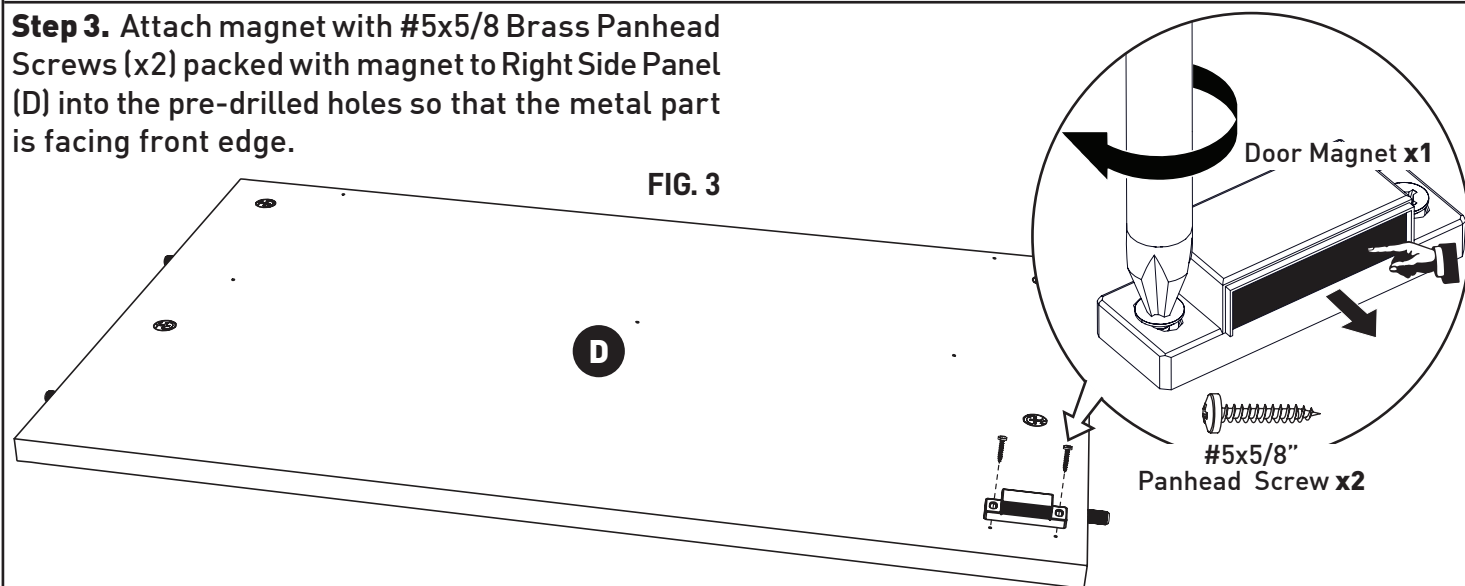

Step 4. Turn Bottom (B) panel over and install the Locking caster on right front and Non-locking casters in the back and left front using the

preinstalled threaded seats and placing Caster washer between caster and cabinet bottom. Tighten with spanner.

FIG. 4

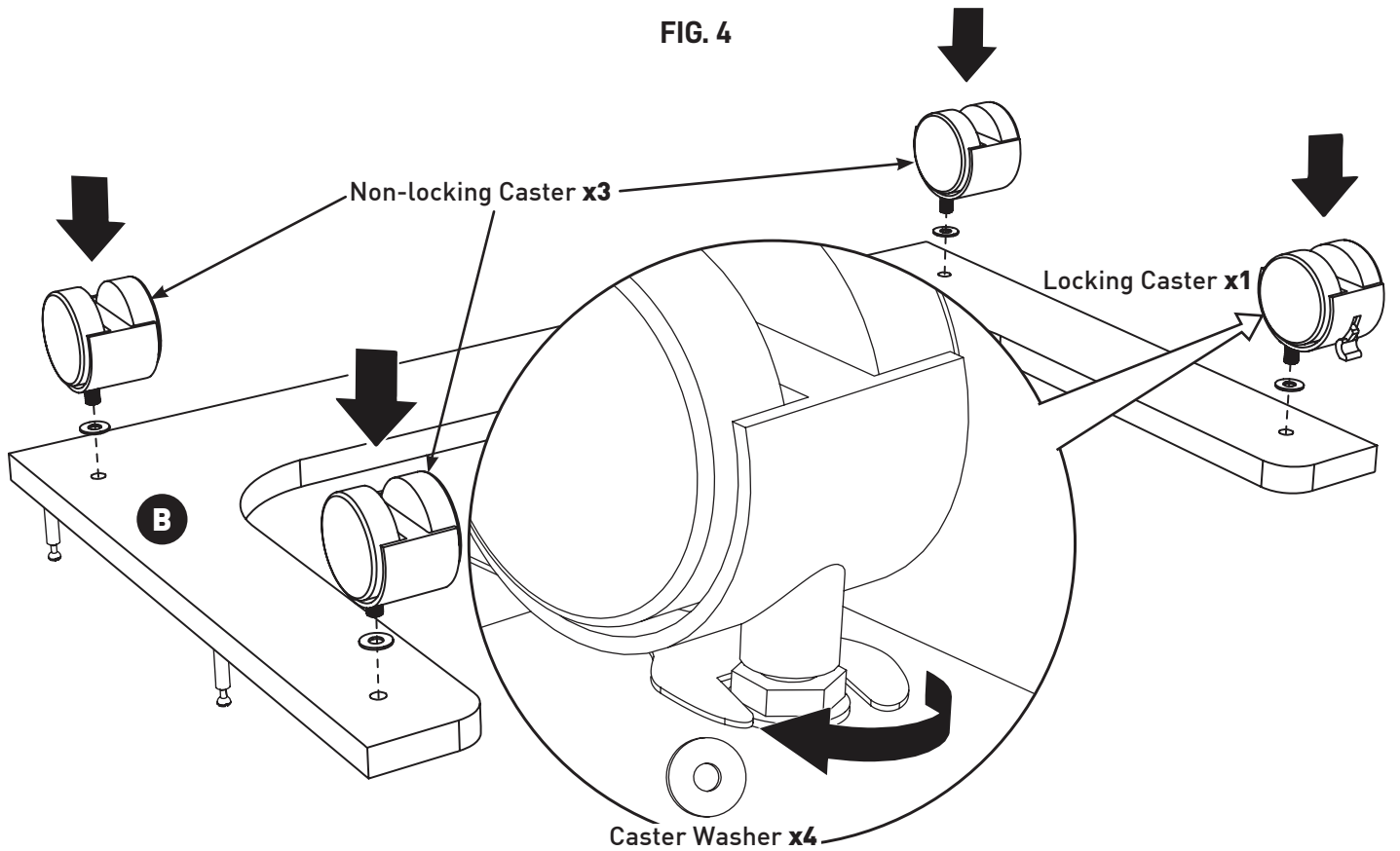

Step 5. Install Lifter rails on Left (C) and Right (D) Side Panel using pre-drilled holes with 6 Screws M4x14mm. Top of rail is even with top of panel.

FIG. 5

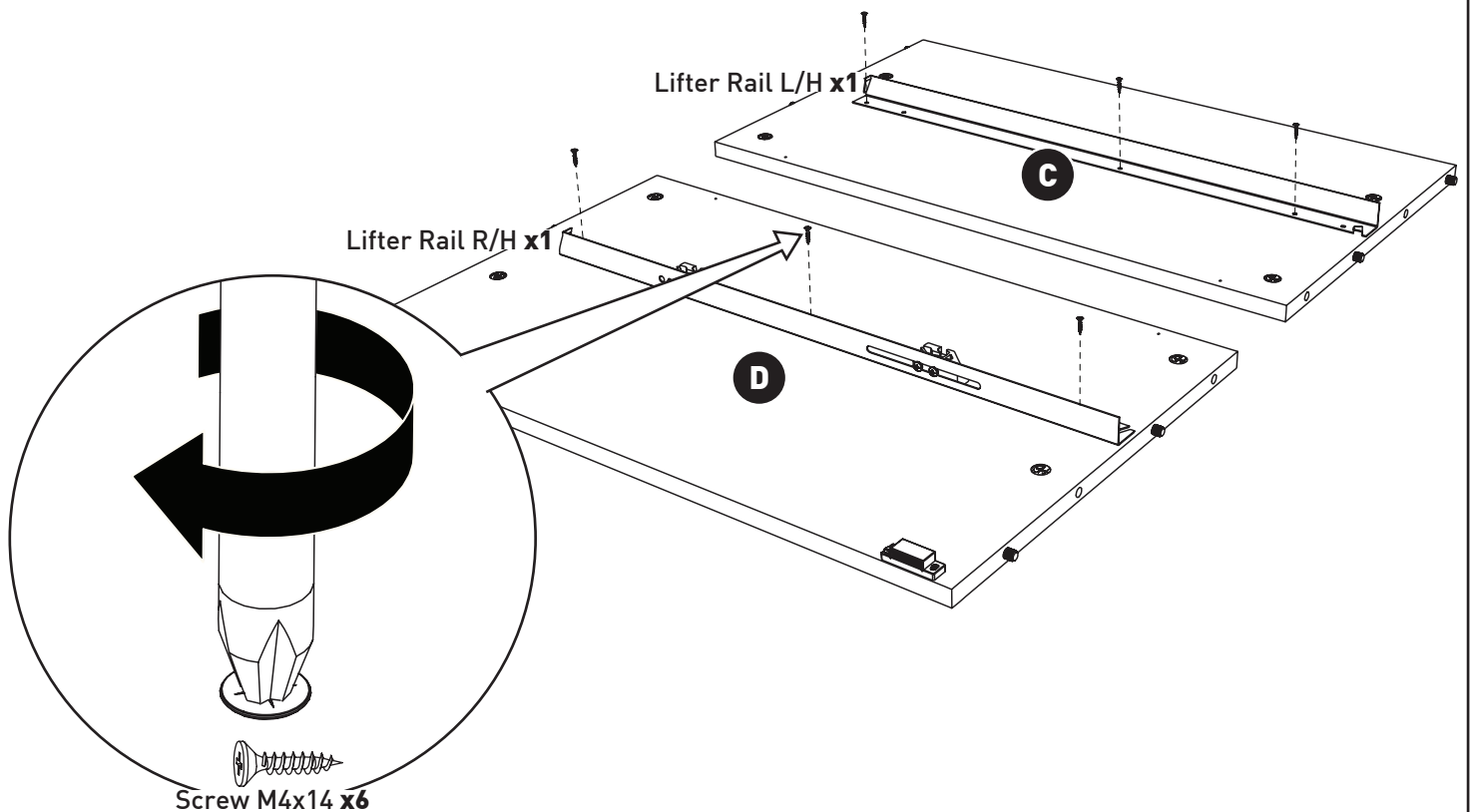

Step 6. In each of the two Door Bin Sides (I) panels, install 10 mm cams (x8) with arrow on cam pointing to hole on outer edge as shown in FIG. 6.

In Door Bin Bottom Panel (J) install Wood dowels (x6) in the holes on all sides.

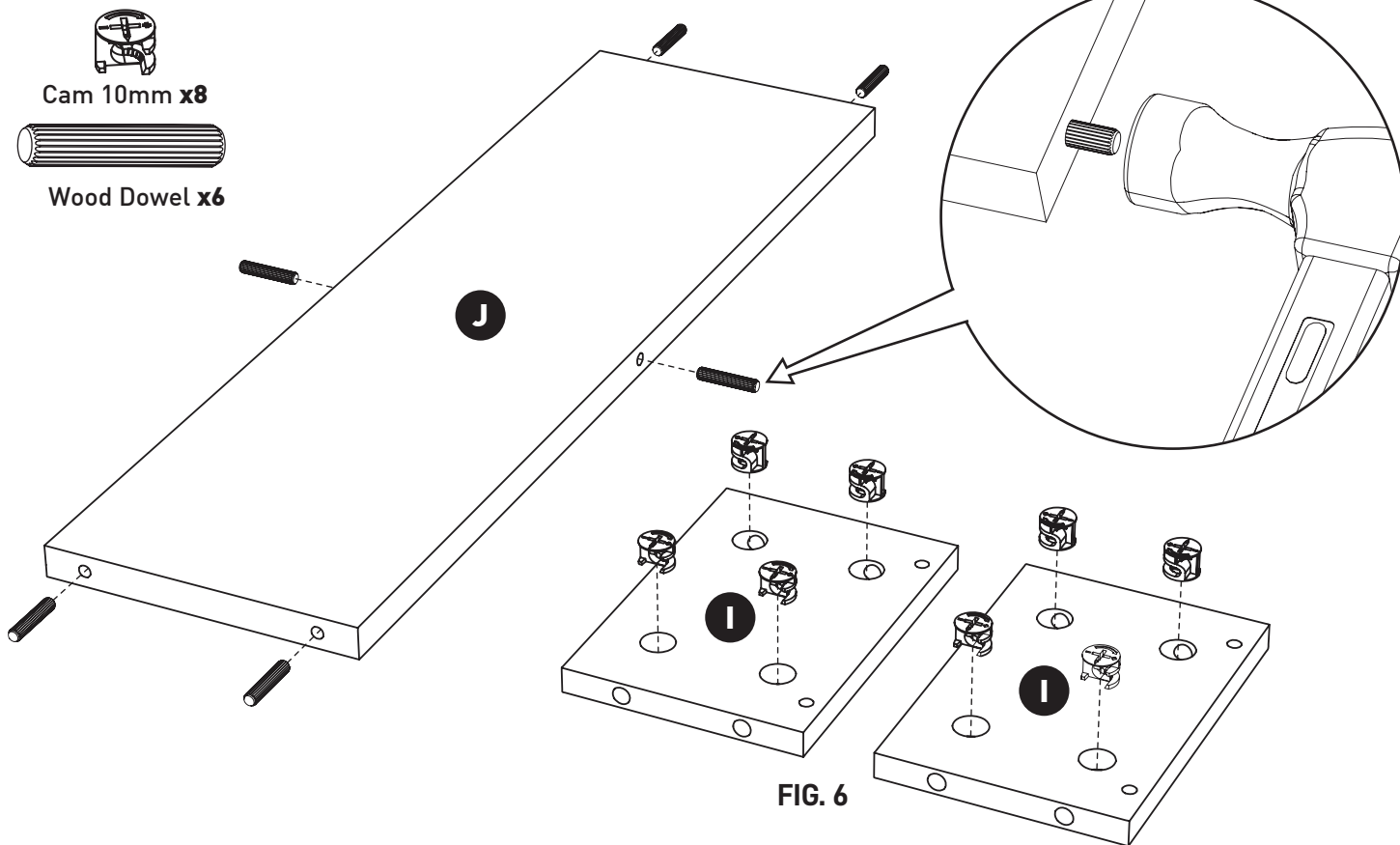

FIG. 6

Step 7. Attach Sides (I) to Bottom panel (J) by pushing dowels on short sides of J into holes on sides I (FIG. 7).

Attach Front Panel (H) to unit by inserting cam bolts into Sides (I) and seating dowel from Bottom (J) (FIG. 8).

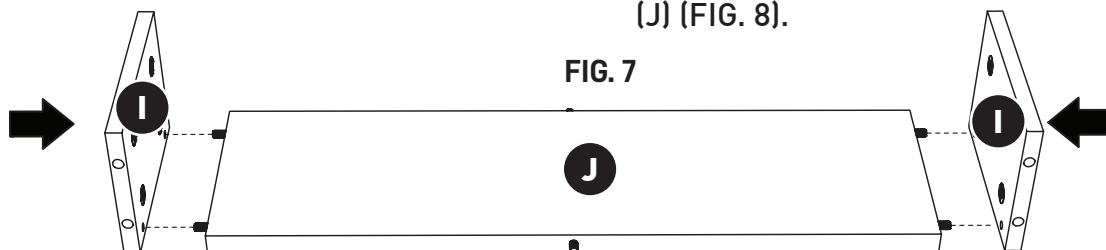

FIG. 7

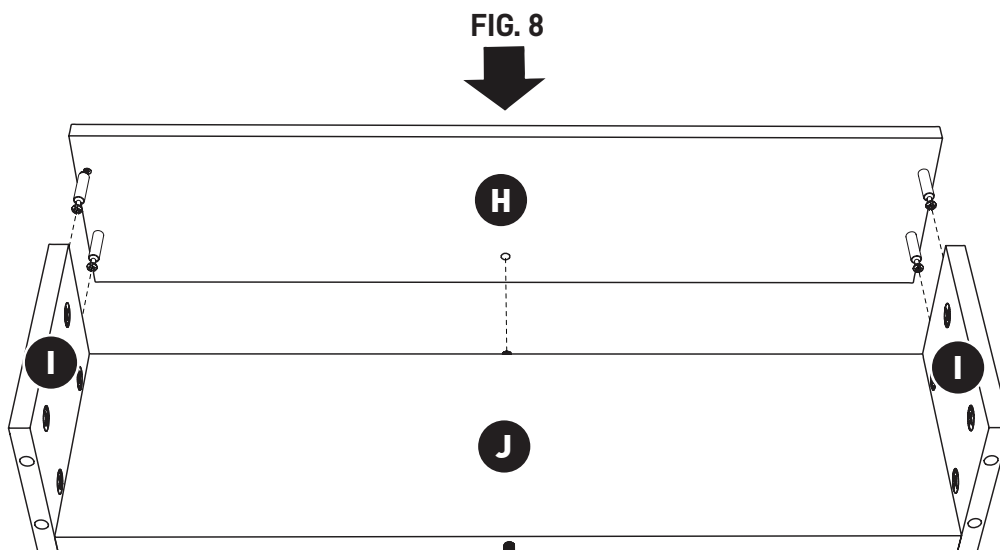
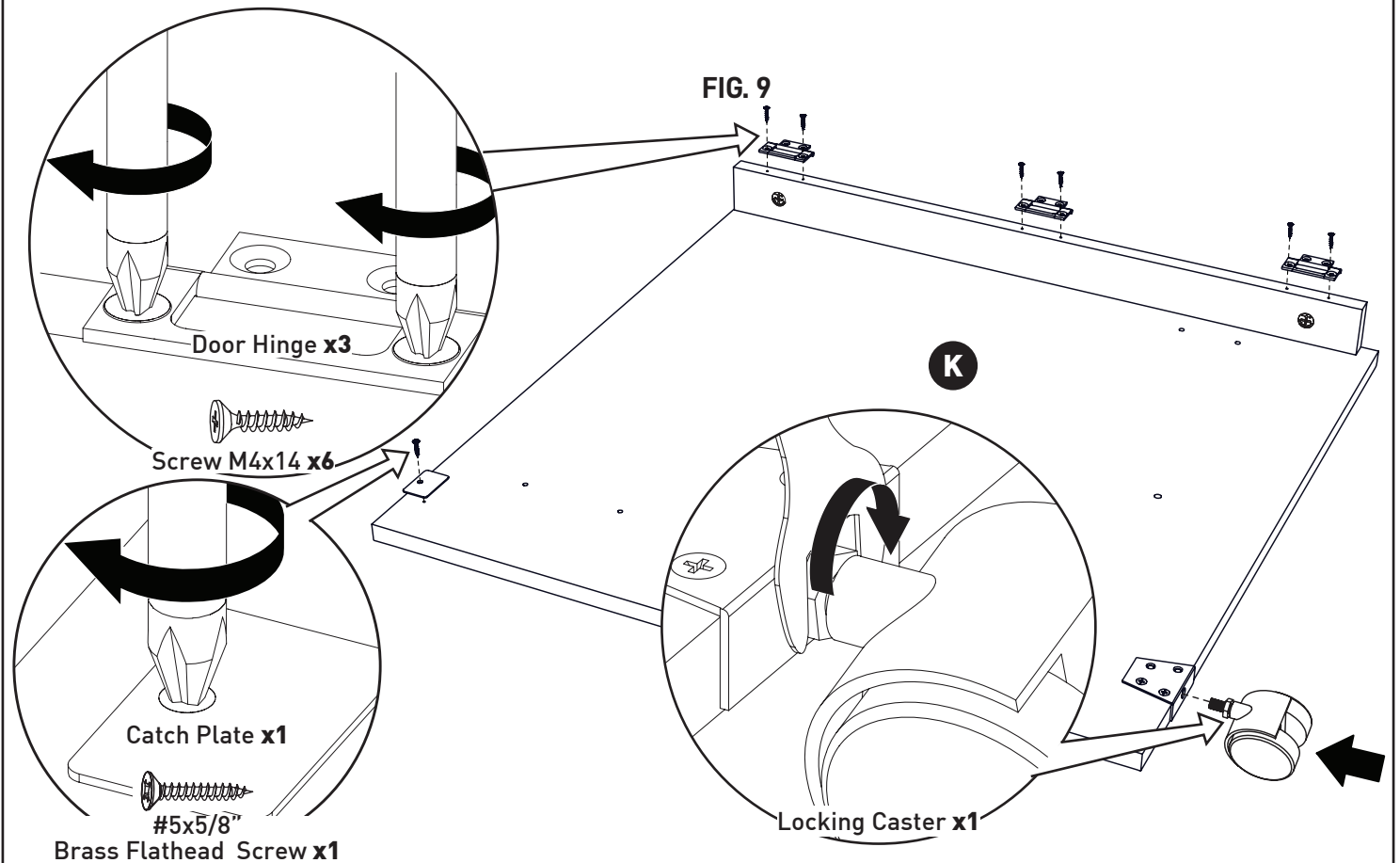

FIG. 8

Step 8. Using 2 Screws (M4x14mm) for each door hinge attach hinges to raised section of Door (K). Attach Door catch plate with screw included in

hardware bag (#5 x 5/8 Brass Flathead Screw). Install the Locking caster through caster plate on bottom of Door (K).



Step 9. Place Bottom Panel (B) on level surface with cam bolts and dowels up. Place Left (C) and

Right (D) Side Panel on Bottom (B) with cam bolts in cam holes and dowels aligned. Tighten 4 cams.

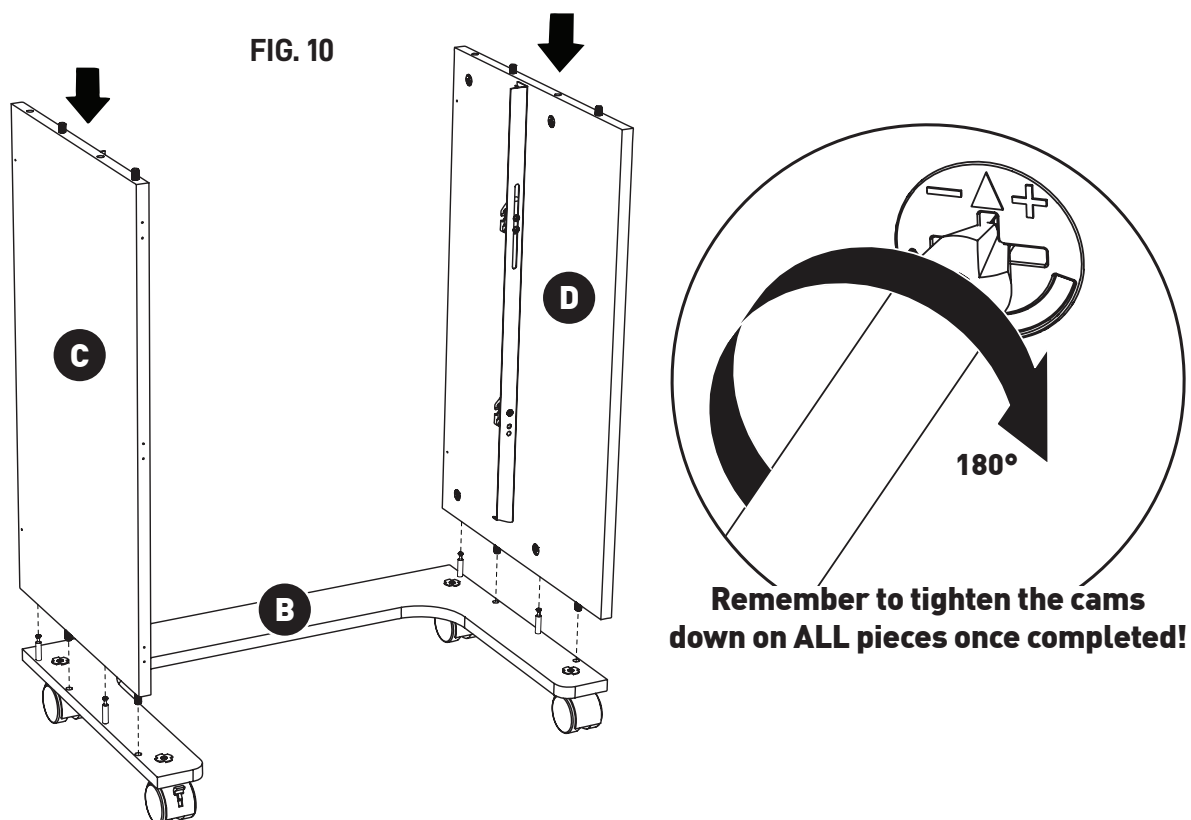

Step 10. Set Back Panels (E) between panels C and D. Insert the Screw 10x60mm (x4) through

holes in side panels into back and tighten 2 screws on each side. Press screw head covers in place.

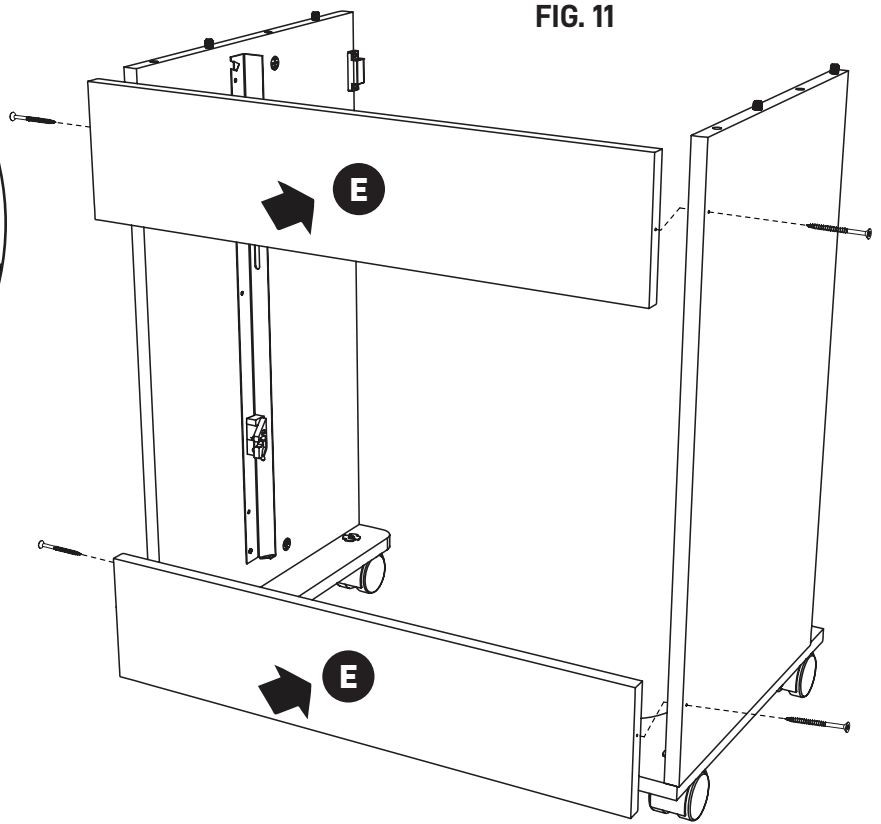
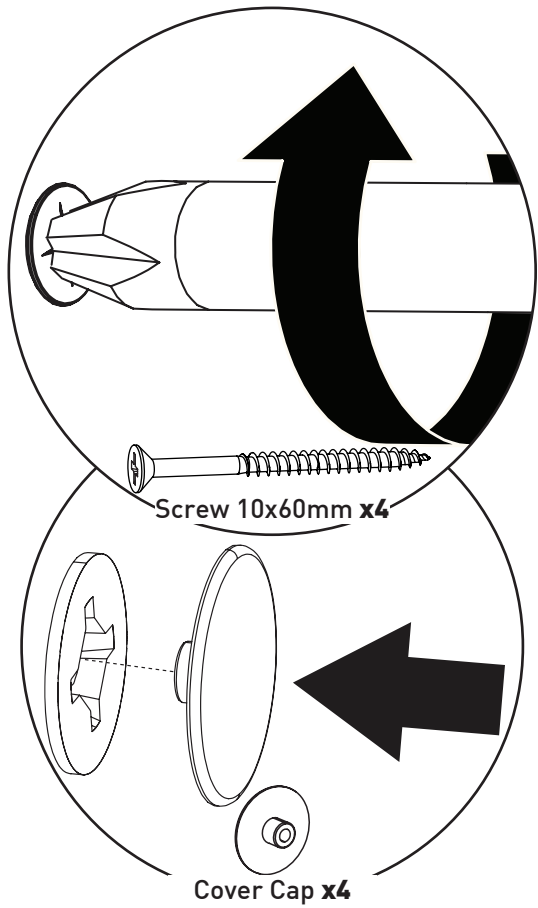

Step 11. Attach the Lifter Board (F) to Lifter unit with Screws M4x14mm (x4).

FIG. 12

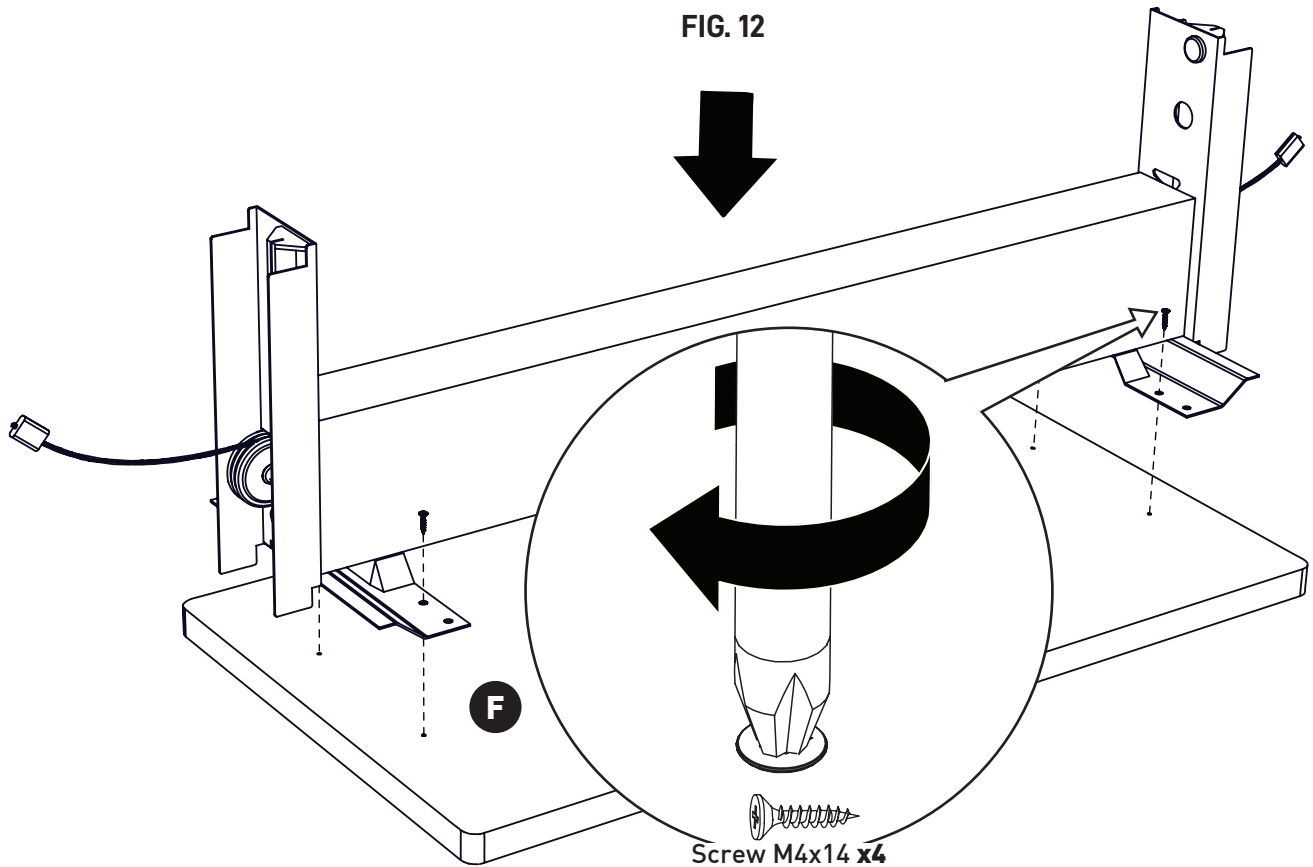

Step 12. Install the lifter onto side rails following these steps.

- A. Position lifter guides (white plastic) over rails and gently slide the lifter into position.
- B. Loop Cable through Metal Tab on top of each lifter rail and secure. A flat screwdriver blade can

be used to push cord into tab. Push lifter down until it clicks into first position. When lifter has locking in first position, a small block of wood will disengage from the rear of the lifter where it was holding the cylinder, be sure to remove and discard it.

If wood block is dislodged during shipping, please view our video "alternative Airlift" at www.arrowcabinets.com Assembly videos or call 1-800-533-73747.

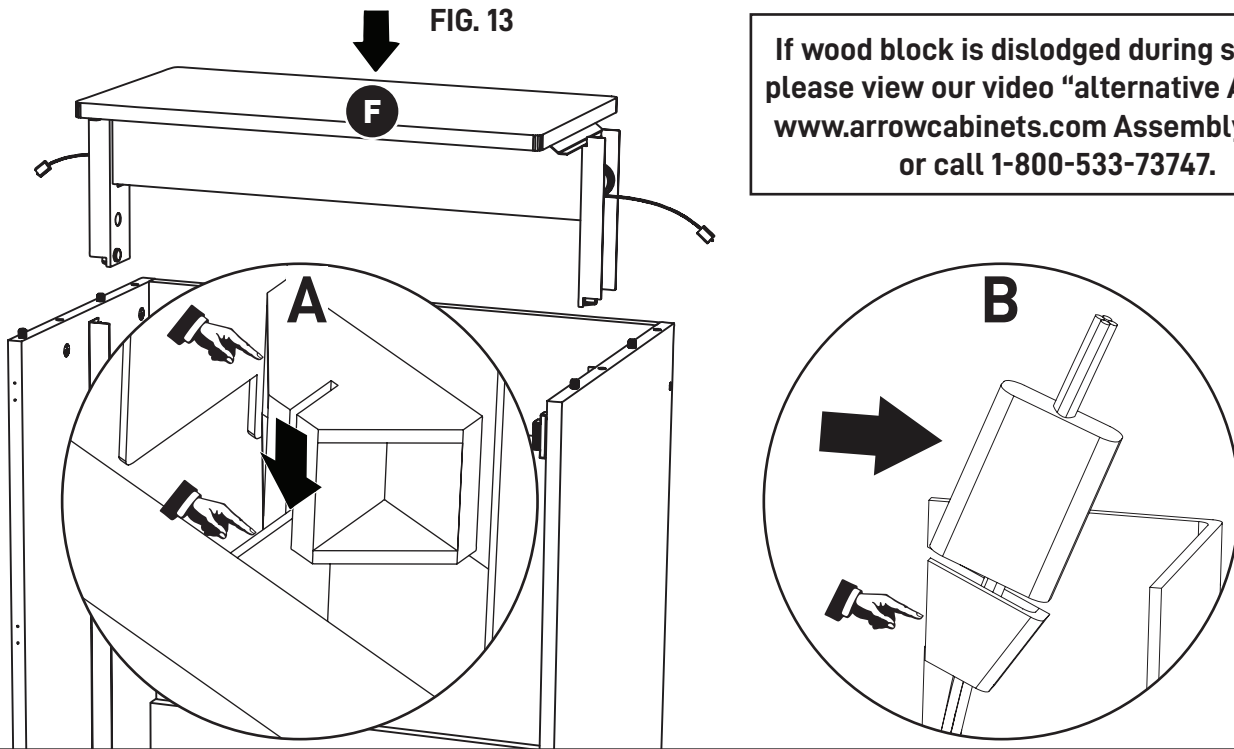

Step 13. Place Top (A) onto the cabinet and tighten 4 cams inside to secure the top.

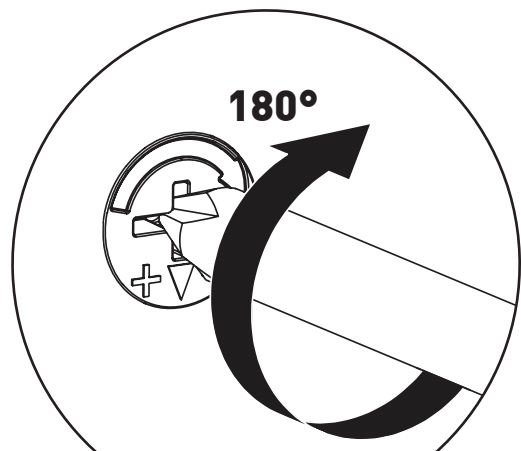

Remember to tighten the cams down on ALL pieces once completed!

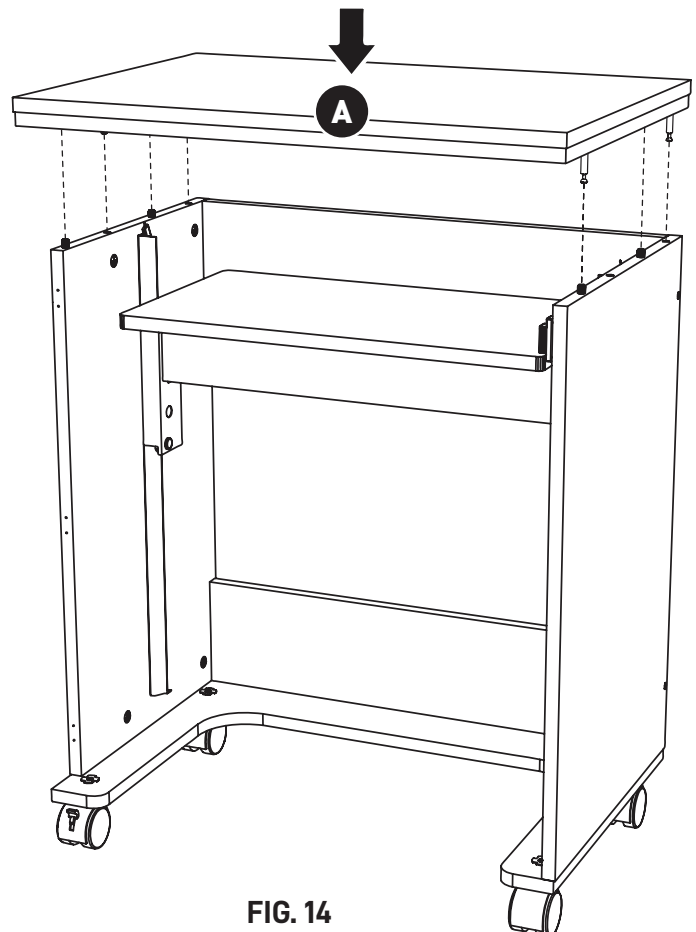
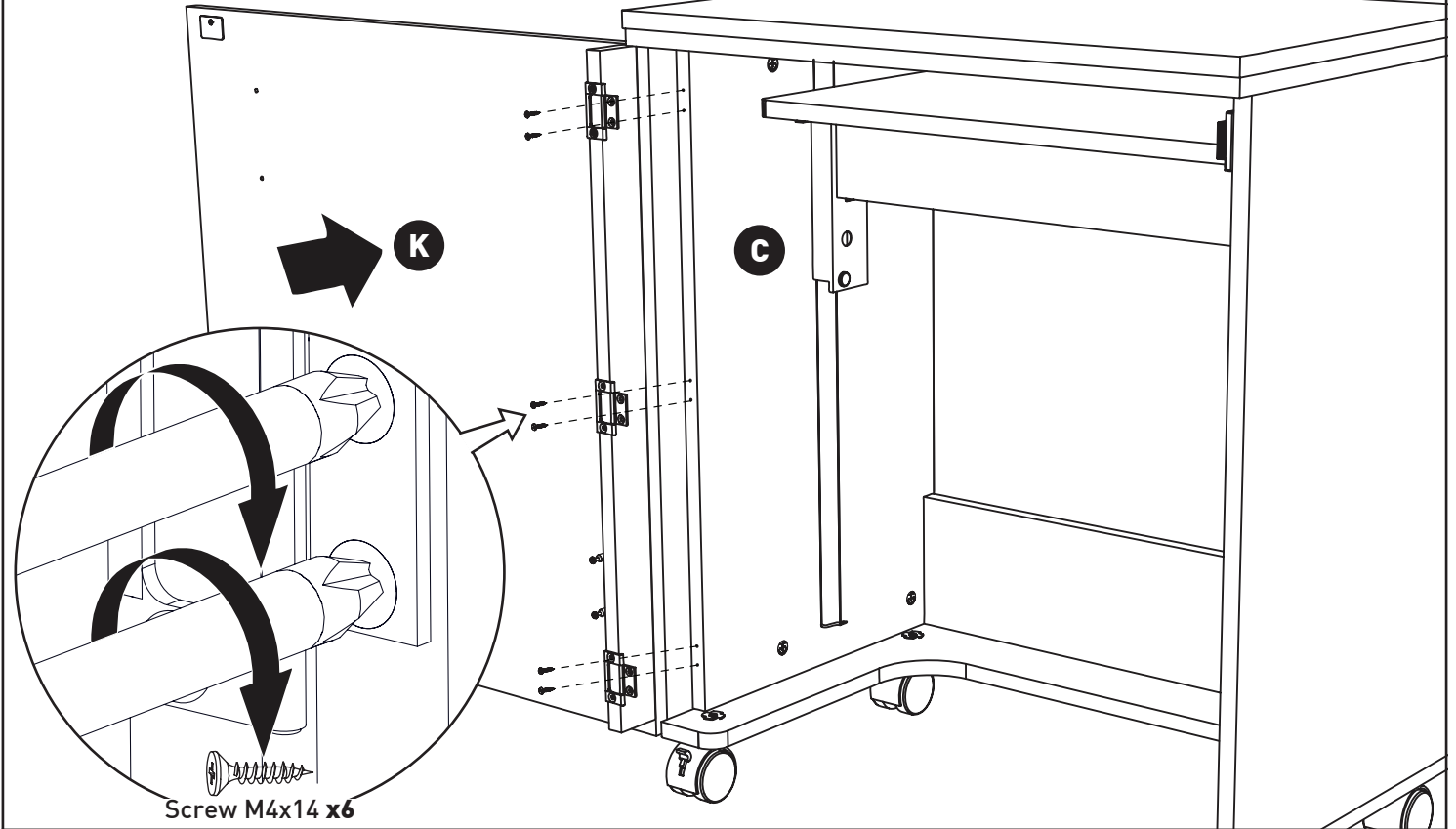

FIG. 14

Step 14. Attach the Door (K) to Left Side Panel (C) with 3 flush door hinges using the 6 remaining Screws M4x14mm.

FIG. 15



Step 15. Add door handle using bolts found with handle.

FIG. 16

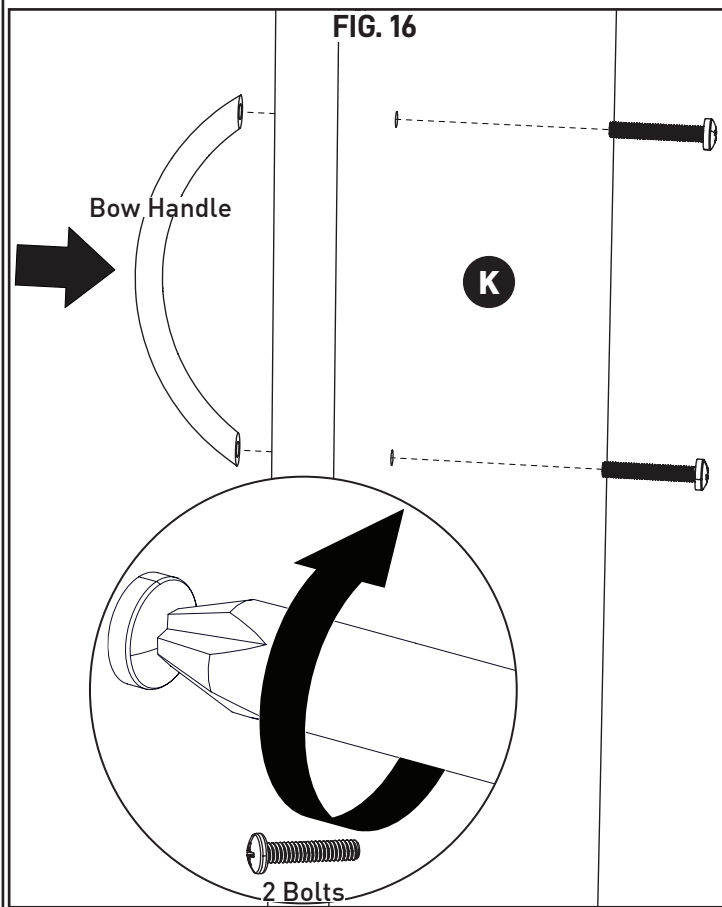

Step 16. Slide the preassembled door bin over the 4 cam bolts and 1 wood dowel found in the Door (K). Tighten the cam bolts to secure.

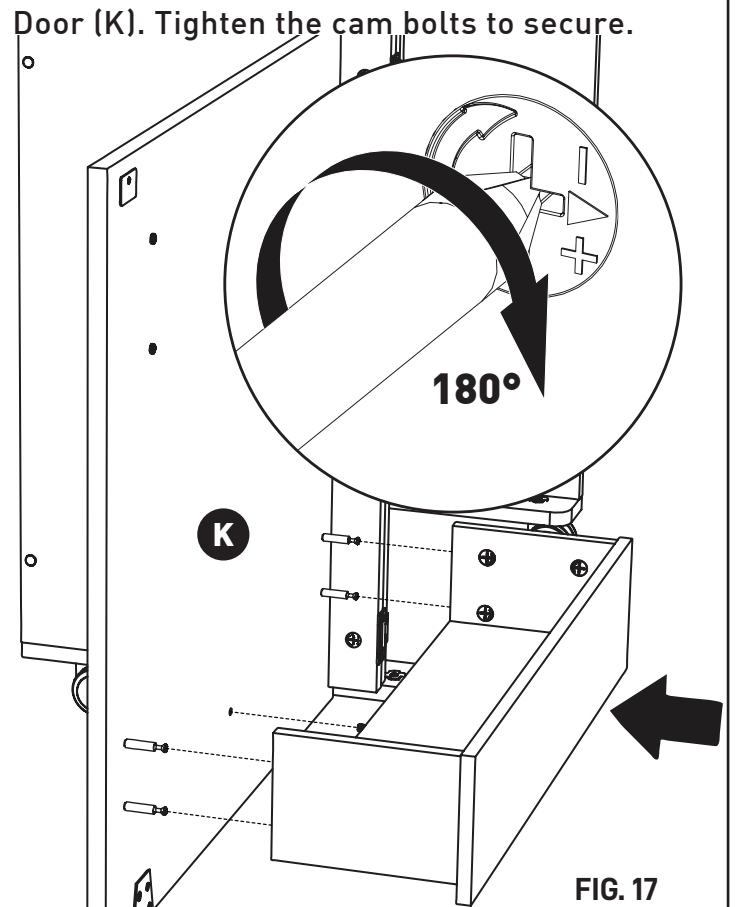
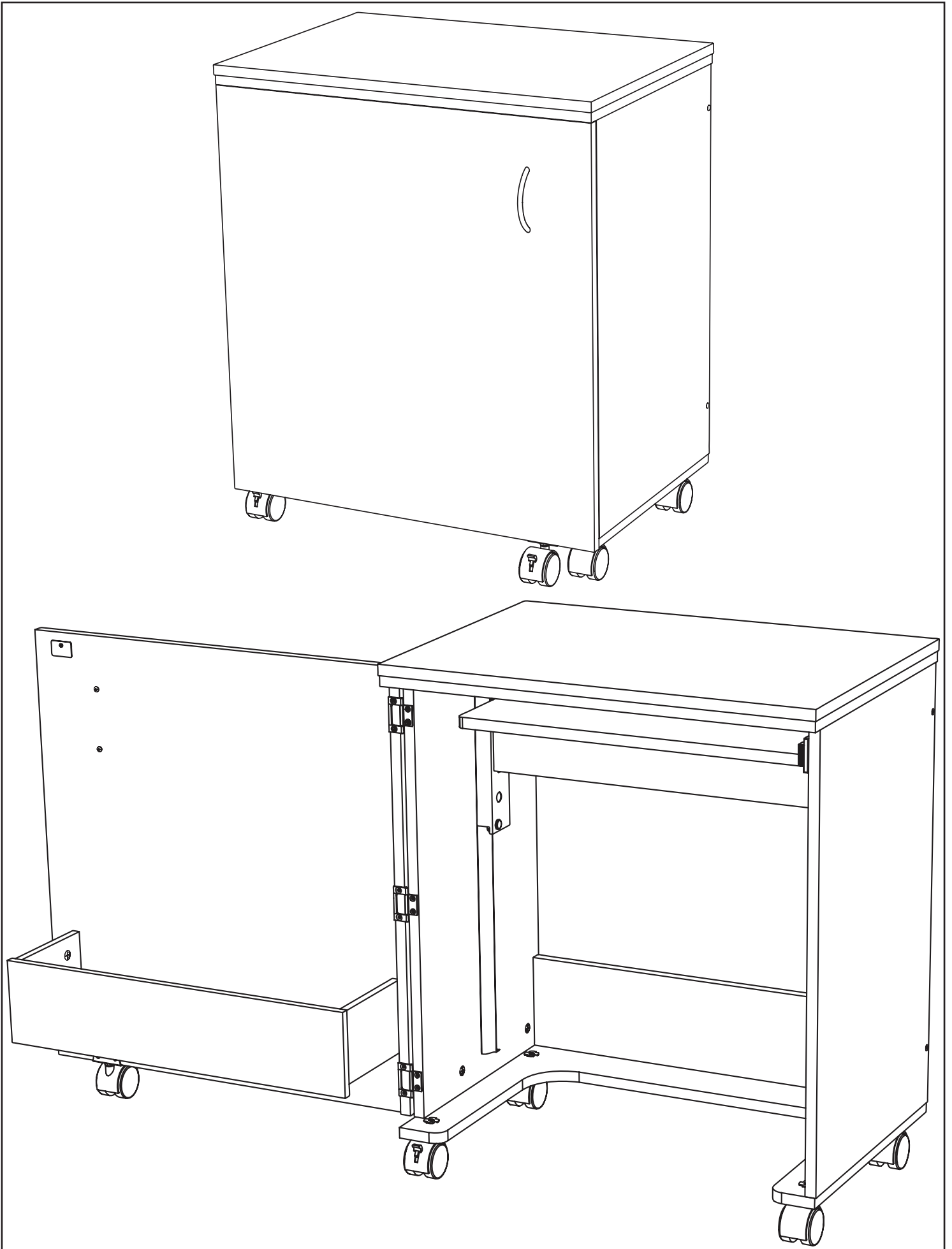

FIG. 17





Accessories to Complete Your Sewing Experience

Custom Insert

Enhance your sewing experience with a custom-made insert for your Arrow or Kangaroo cabinet. Inserts are designed to reduce the gap between the machine and cabinet opening. This provides an ergonomic work surface for the free arm of the sewing machine, allowing for straighter stitches, less fatigue and an overall better experience using your machine and cabinet.

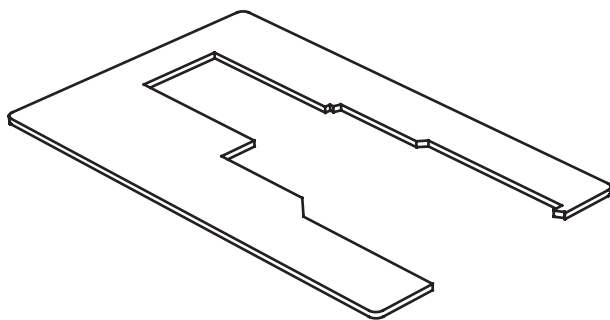

Insert

Arrow Sewing Chairs

Our adjustable height sewing chair is a perfect accessory for any craft and sewing room. The chair's height is adjustable with easy to use controls and the cushions provide perfect lumbar support and comfort for those long sewing hours. Chair features five casters on a star base for greater movement at your sewing cabinet or crafting surface. Lift the seat cushion to reveal a hidden storage compartment for your small notions or patterns.

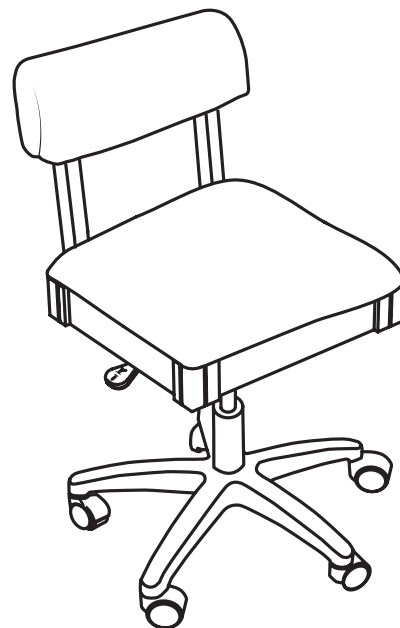

Hydraulic Sewing Chair

P.O. Box 307 Delavan, WI 53115
1-800-533-7347 Ext. 1
cs@arrowcabinets.com
www.arrowcabinets.com